

Sustainable Design

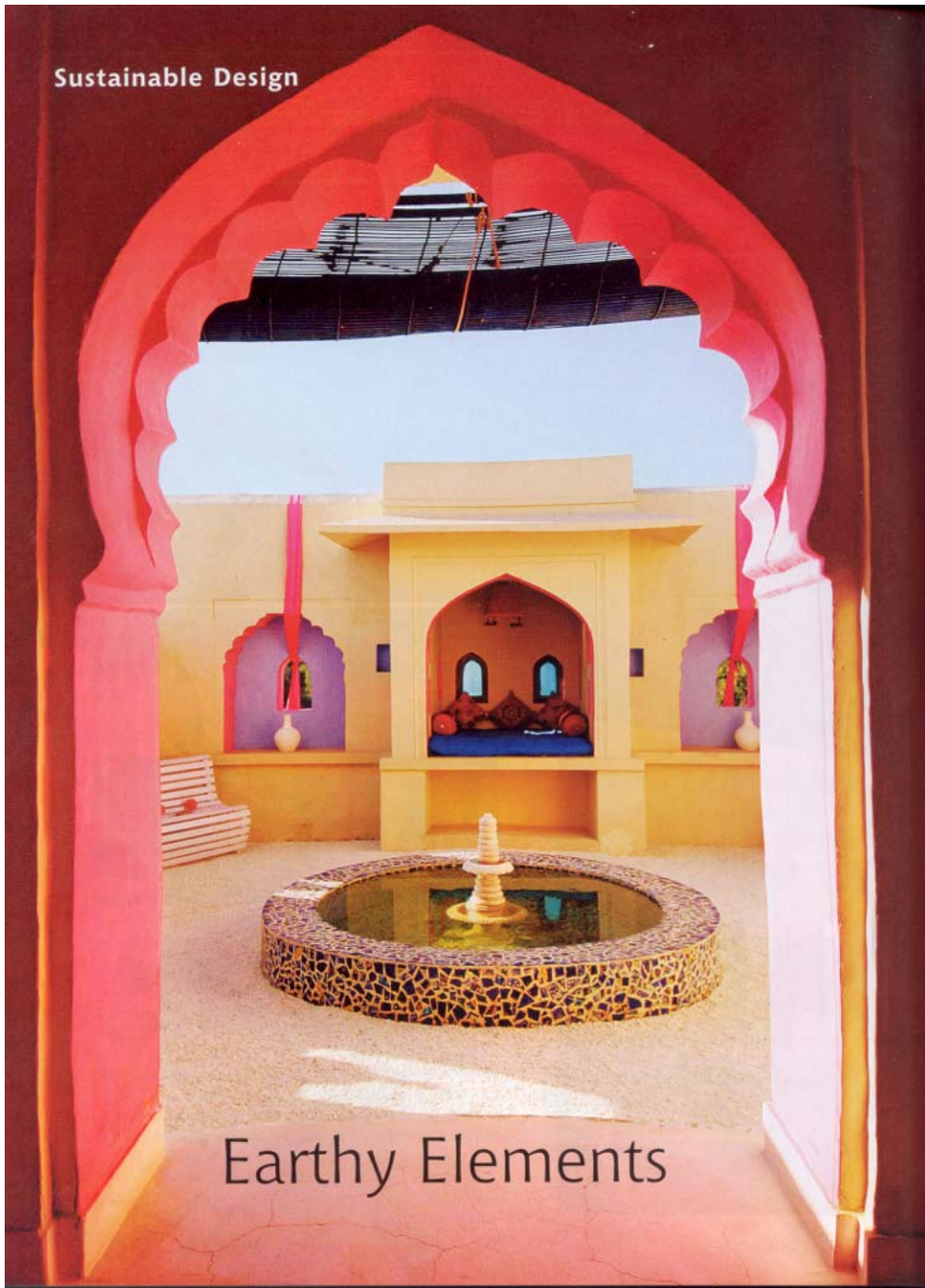

Earthy Elements

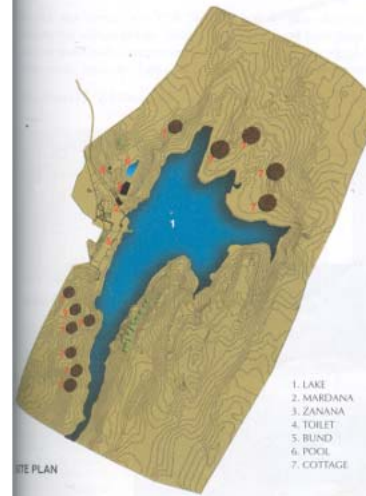

SITE PLAN

1. LAKE
2. MARDANA
3. ZANANA
4. TOILET
5. BLIND
6. POOL
7. COTTAGE

Project: Lakshman Sagar Resort, Raipur, Rajasthan
Architects: Kamath Design Studio, New Delhi

The Lakshman Sagar Lake, located at the foothills of the Aravallis, is the focus of the resort. The rocky site was the location of a 19th century hunting lodge of the Thakur of Raipur.

A colonnaded verandah overlooking the plains and the lake on either side constituted the Mardana, while a Haveli enclosing a courtyard, stepping up three floors, was used as the Zanana. These buildings were restored with minimum intervention and used as the public areas of the resort. Adjacent to the Zanana, a swimming pool was dug out of the rock. Fissures in the geological formations, guided the shape and form of the pool.

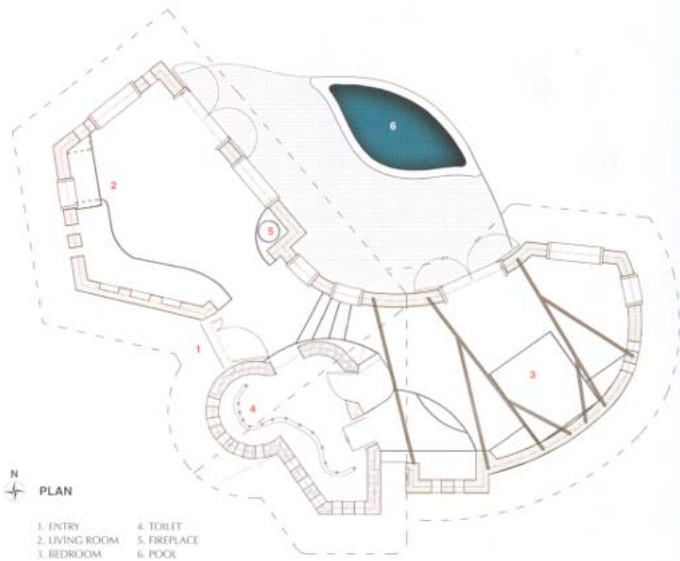

TYPICAL COTTAGE



SECTION

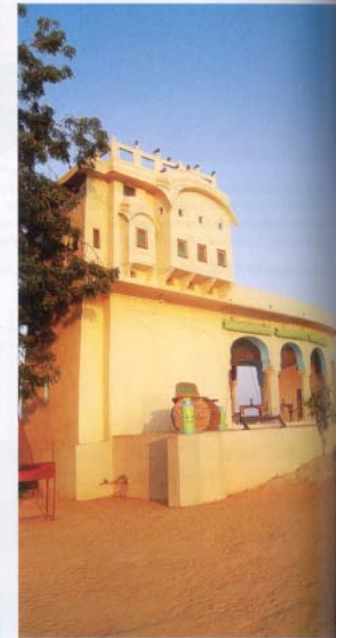
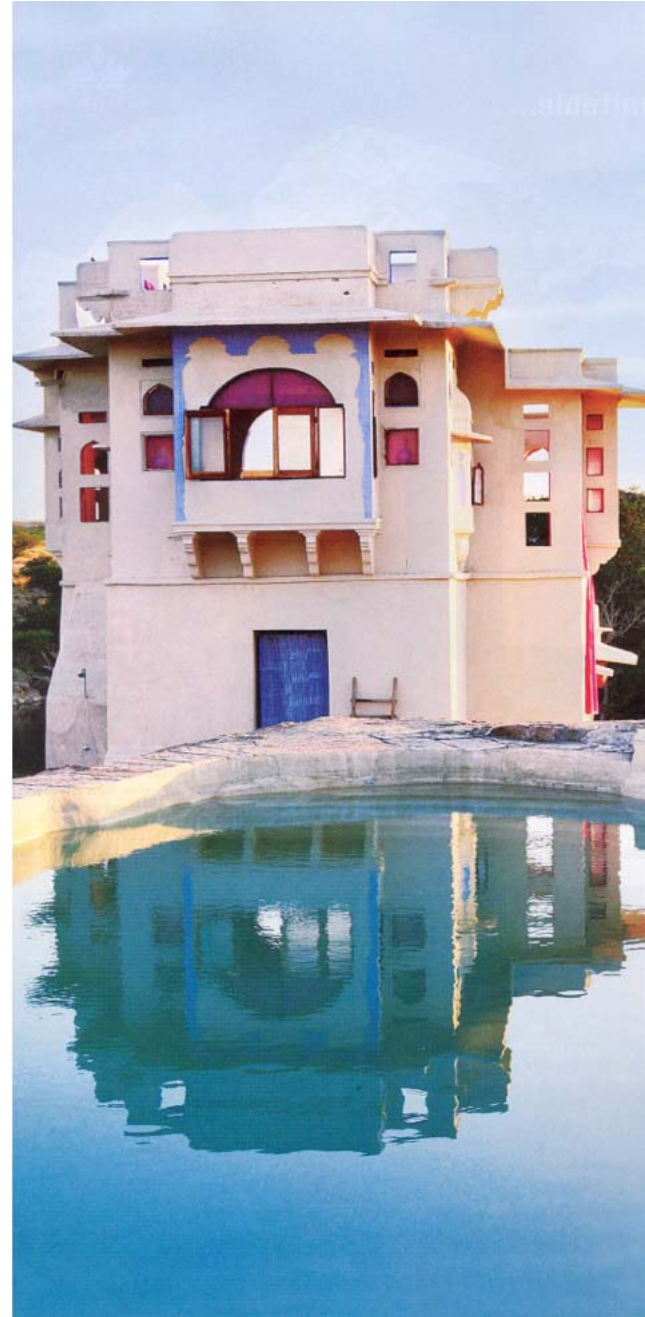
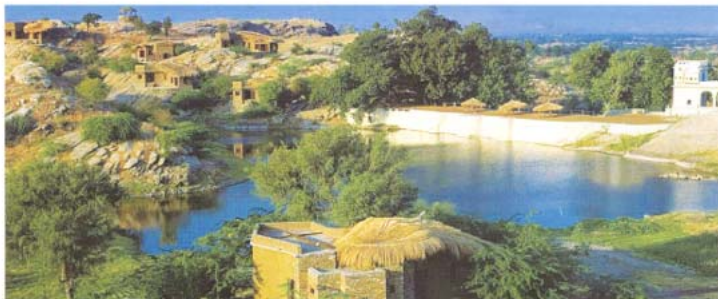

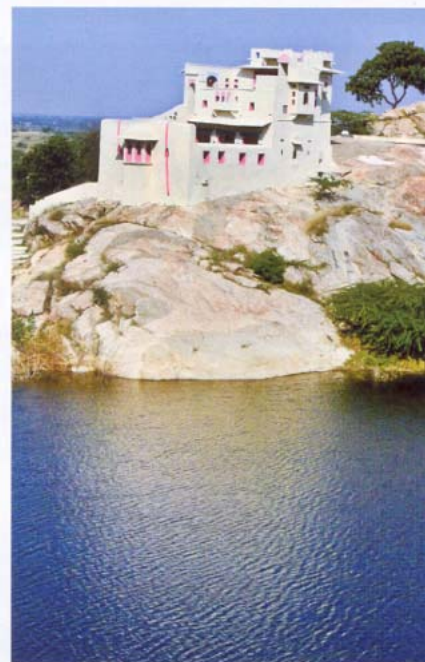
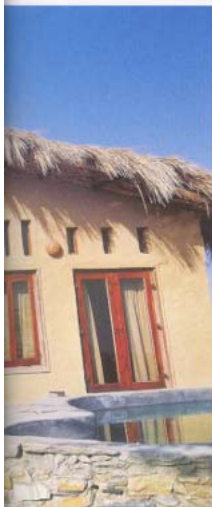

The 12 cottages were located in two clusters on either side of the facilities. An additional 20 are envisaged on the 32-acres of land. The natural pathways that responded to the topography of the site were gradually softened by constant use by the labour as well as the donkeys that carried construction material.

The cottages were carefully located, so that they did not block each others' views and ensured privacy.

Once the cottages were located, the generic designs were modified to suit each specific location. The view, the trees, the rocks and boulders, the wind, sun and the water courses were taken into account, while honing the spatial configurations.

To reduce the carbon footprint, all materials used for construction and design were locally sourced from the immediate surrounding areas. Use of materials such as marble and glass were kept to a minimum. The construction materials were kept to the basics – slate and boulders for the foundations, sun dried mud bricks for the walls with door and window frames of local sandstone. Slate slabs were used as lintels, bracket, cills and roofing slabs. Timber ballis, of both *Kikar* (Acacia) and eucalyptus were used as beams, supporting both the stones and timber planks of the roofs. A green roof was envisaged over the sloping timber planks.

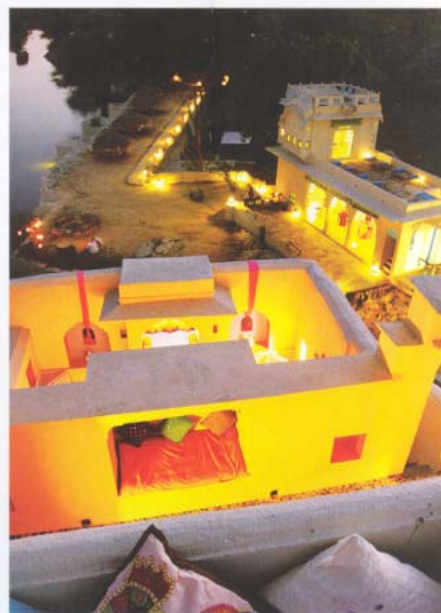

The style and interiors of Lakshman Sagar were inspired by an understanding of the local life in Marwar and the Pali District. The colours used on the property, the Zanana tables inspired by local Rajasthani women, or light fittings made of milk cans reflect a conscious effort to draw out the otherwise unexplored nuances of the local culture for the traveler.

The bathrooms were constructed of slate. Ashtrays, tissue boxes and the faucets in the sink have been made from the remains of the rocks used for construction. Table tops in the cottage living room area, coasters and venue signages have been made out of the left-over wood. The flooring was of local Bidasar marble. The clients were totally involved in the implementation of the project, sourcing materials, understanding the design and drawings and transmitting it to the site. They also continue to uphold the 'zero kilometer concepts' in the daily running of the resort. ✦

FactFile

- Client:** Sewara
- Design team:** Revathi and Vasant Kamath
- Consultants:** Sahil Bagga and Sarthak Sengupta (Interiors)
- Contractors:** Sewara and local artisans
- Built-up area:** 1500sq m of cottages + 500sq m for conservation, additions and alteration + 400sq m of service block
- Year of completion:** 2010